

No. 6826CE

Heavy pneumatic toggle clamp

with vertical cylinder attachment.
 With swivel mounting and adjustable end position cushioning.
Magnetic piston for end-position monitoring. Tempering steel, burnished. The axle bolts running in bearing bushes are tempered, ground and locked with circlips.
 Clamp is ready for installation and consists of:
 - toggle clamp element no. 6816CE
 - double acting FESTO pneumatic cylinder.
 These cylinders are made to
 - ISO 6431
 - VDMA 24562
 - NFE 49003.1
 - UNI 10290

Order no.	Size	F1 [kN]	F2 [kN]	F3 [kN]	F4 [kN]	F5 [kN]	Vn [dm ³]	Weight [g]
92296	4	6	9	1,5	2,2	0,75	1,0	5070
92304	6	12	18	2,5	3,5	1,00	1,8	7700
92312	8	20	30	4,0	6,0	1,80	4,3	17800

F3+F4 = maximum clamping force at 6 bar.
 Vn = Air consumption per double stroke in dm³ at 6 bar.

Application:

These pneumatic toggle clamps are of machine tool quality and can be installed in machines such as material handling lines and special machines. Opening and clamping position of the clamp can be controlled electrically and can be integrated into automated manufacturing.

Note:

Suitable proximity switches for end-position monitoring are available using order no. 392241.
 Design: PUR cable 0.3 m with M8 plug connection and rotating knurled nuts.
 Switching function: NOC.
 Output: PNP.

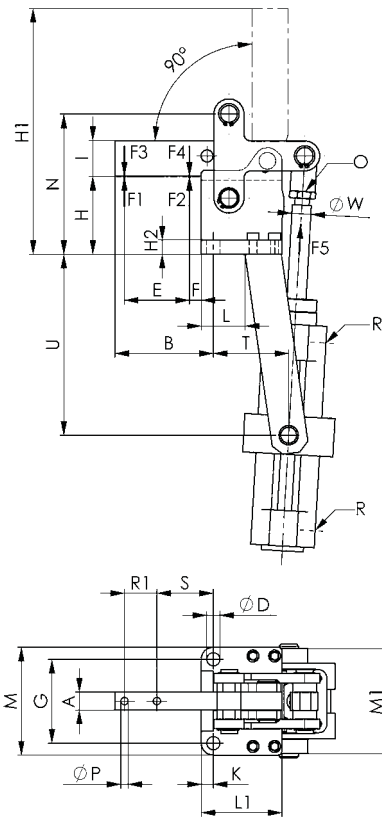

Recommendations



Dimensions:

Order no.	Size	A	B	dia. D	E	F	G	H	H1	H2	I	K	L	L1
92296	4	15	82	11	54	10,0	70	65	205	12	30	10	36	67,0
92304	6	20	91	13	60	10,0	83	69	226	15	40	12	32	73,5
92312	8	30	125	17	95	9,5	115	94	318	20	60	15	49	109,0

Order no.	Size	M	M1	N	O	dia. P	R	R1	S	T	U	dia. W	Piston dia.	Piston stroke
92296	4	90	87,5	117	M12x1,25	6,2	G1/4	27	47	63	151	16	40	80
92304	6	107	100,0	137	M16x1,50	8,2	G1/4	26	54	64	186	20	50	100
92312	8	145	115,0	184	M16x1,50	13,2	G3/8	40	67	101	192	20	63	125

Piston dia. = Cylinder dia. required for piston force F5 at 6 bar air pressure.



Subject to technical alterations.